



ITG Maxogen Filter Guide

April 2021



**JC60 Pleated Conical
Aluminium Spinning**



**JC60 Pleated Conical
(Rubber Neck)**



JC62



Small
Cone



Rubber
Neck



Full
Cone



Large
Cone



Mega
Maxogen



Pleated Cotton Gauze Conical Filters

Part No.	Description
JC60 Pleated Cotton Gauze Conical Filters	Filter sizes /67RP/73RP/78RP
	/86RP/99RP
JC60 Rubber Necked Pleated Cotton Gauze Conical Filters	Filter sizes RN/70P, RN/76P, RN/80P
	RN/89P, RN/102P, RN/114P, RN/127P

Foam Conical Filters

Part No.	Description
JC62	Filter sizes /60/70
JC60 Small Cone	Filter sizes /58C/60C/63C/67C/70C/73C/78C/84C
JC60 Rubber Neck (Small Cone)	Filter sizes RN/70C, RN/76C, RN/80C
JC60 Full Cone	Filter sizes /58FC/60FC/63FC/67FC/70FC/73FC/78FC/84FC
JC60 Rubber Neck (Full Cone)	Filter sizes RN/70FC, RN/76FC, RN/80FC
JC60 Large Cone	Filter sizes /80C/86C/93C/99C/114C/124C
JC60 Rubber Neck (Large Cone)	Filter sizes RN/89C RN/102C RN/114C RN/127C
JC60 MegaMaxogen	Filter sizes /80MM/86MM/93MM/99MM/114MM/124MM
JC60 Rubber Neck (Mega Maxogen)	Filter sizes RN/89MM, RN/102MM, RN/114MM, RN/127MM



JC60/**XX**RP Pleated Cotton Gauze Conical Filters

ITG's new Cotton Gauze JC60 range are uniquely built onto a matt black aluminium spinning, which unlike other available items on the market funnels air smoothly into the intake system. All JC60 Pleated Maxogens will be available to purchase with a foam oversock, for ultimate dust capture capability.

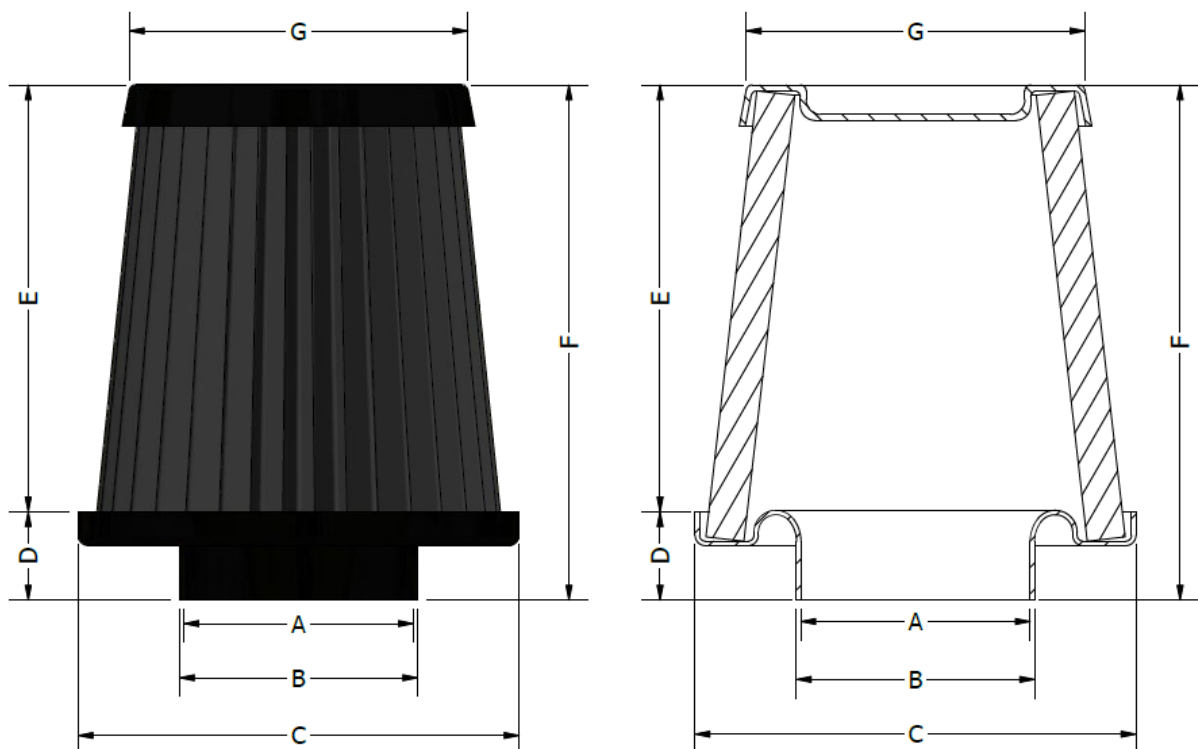

Part	A	B	C	D	E	F	G
Number	Neck	Neck	Spinning	Spinning	Pleat	Total	Top
	ID	OD	Diameter	Height	Height	Height	Diameter
JC60/67RPF	67	70	149	30	145	175	115
JC60/73RPF	73	76	149	30	145	175	115
JC60/78RPF	78	81	149	30	145	175	115
JC60/86RPF	86	89	181	28	145	173	115
JC60/99RPF	99	102	181	28	145	173	115

Website Link: <https://www.itgairfilters.com/product/jc60rpf-aluminium-spinning-jc60rpf/>



JC60RN/XXP Rubber Neck Pleated Cotton Gauze Conical Filters

These Rubber Neck filters are a direct equivalent filter to our conventional Aluminium Based JC60 Pleated Cotton Gauze filters. They are to be used where a filter is required to clamp directly onto hard intake pipework – therefore eliminating the need for a silicone joiner section.

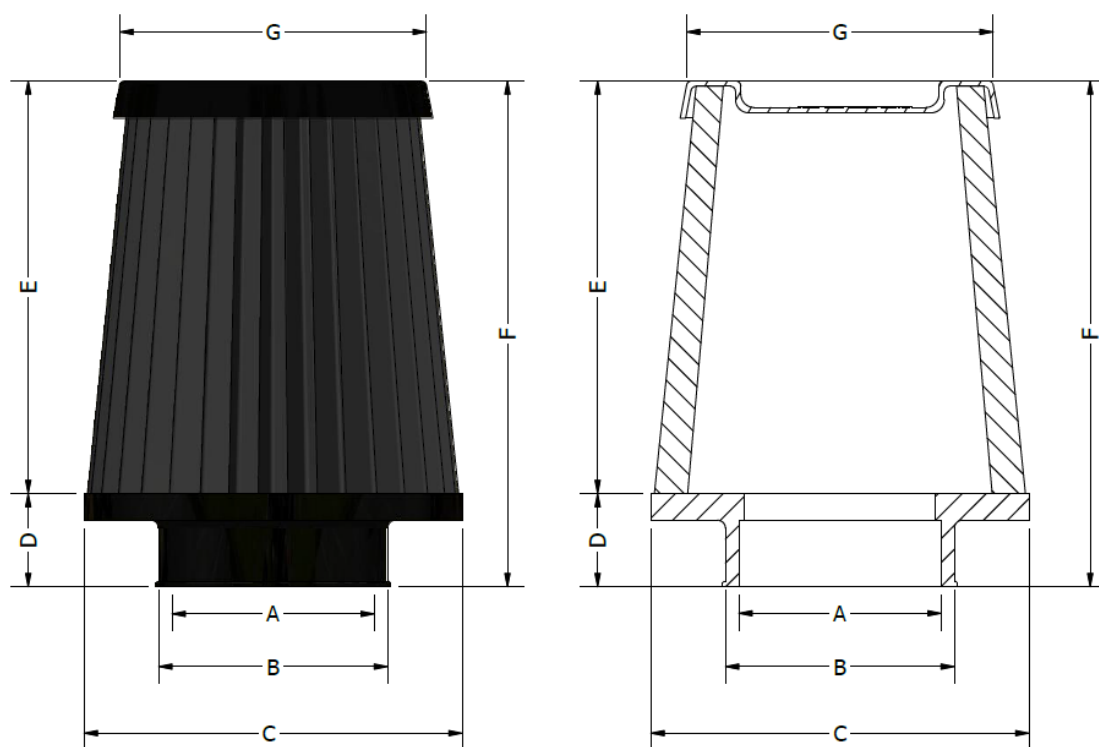

Part Number	A	B	C	D	E	F	G
	Neck	Neck	Base	Base	Pleat	Total	Top
	ID	OD	Diameter	Height	Height	Height	Diameter
JC60RN/70P	70	80	150	35	148	183	115
JC60RN/76P	76	86	150	35	148	183	115
JC60RN/80P	80	90	150	35	148	183	115
JC60RN/89P	89	99	180	35	148	183	115
JC60RN/102P	102	112	180	35	148	183	115
JC60RN/114P	114	124	180	35	148	183	115
JC60RN/127P	127	137	180	35	148	183	115

Website Link: <https://www.itgairfilters.com/product/jc60rnp-rubber-neck-jc60rnp/>



JC62 Conical Filters

This much smaller filter is best suited to smaller capacity normally aspirated engines. These are typically used on Formula Student cars.

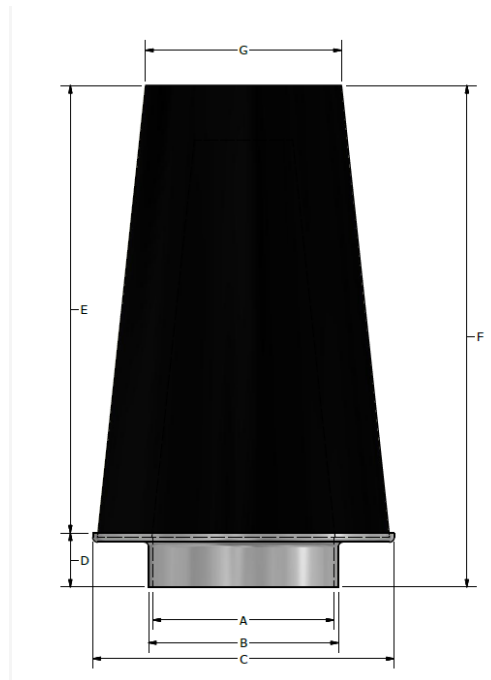

Part Number	A Neck ID	B Neck OD	C Spinning Diameter	D Spinning Height	E Foam Height	F Total Height	G Top Diameter
JC62/60	60	63	100	20	150	170	65
JC62/70	70	73	100	20	150	170	65

Website Link: <https://www.itgairfilters.com/product/jc62-jc62/>



JC60/XXC (Small Cone)

These JC60 filters are built onto our smaller 149mm diameter aluminium spinning. These filters use our small plastic filter support cage which is cut down to give a total foam height of 121mm.

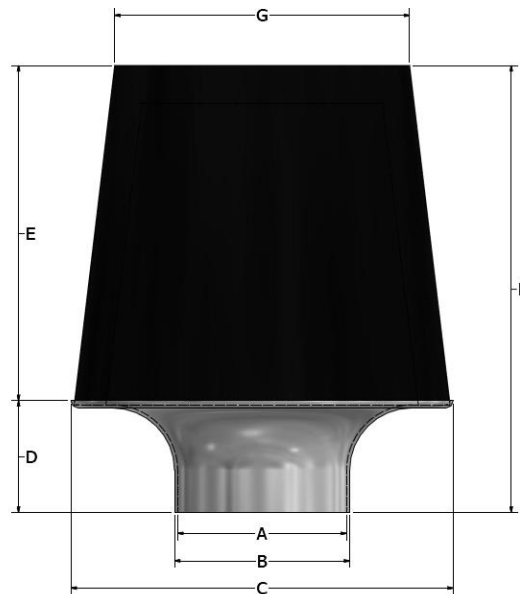

Part Number	A Neck ID	B Neck OD	C Spinning Diameter	D Spinning Height	E Foam Height	F Total Height	G Top Diameter
JC60/58C	58	61	149	30	121	151	114
JC60/60C	60	63	149	52	121	173	114
JC60/63C	63	66	149	52	121	173	114
JC60/67C	67	70	149	54	121	175	114
JC60/70C	70	73	149	54	121	175	114
JC60/73C	73	76	149	50	121	171	114
JC60/78C	78	81	149	44	121	165	114
JC60/84C	84	87	149	46	121	167	114

Website Link: <https://www.itgairfilters.com/product/jc60c-small-cone-jc60c/>



JC60RN/XXC (Rubber Neck Small Cone)

These Rubber Neck filters are a direct equivalent filter to our conventional Aluminium Based JC60 Small Cone filters. They are to be used where a filter is required to clamp directly onto hard intake pipework – therefore eliminating the need for a silicone joiner section.

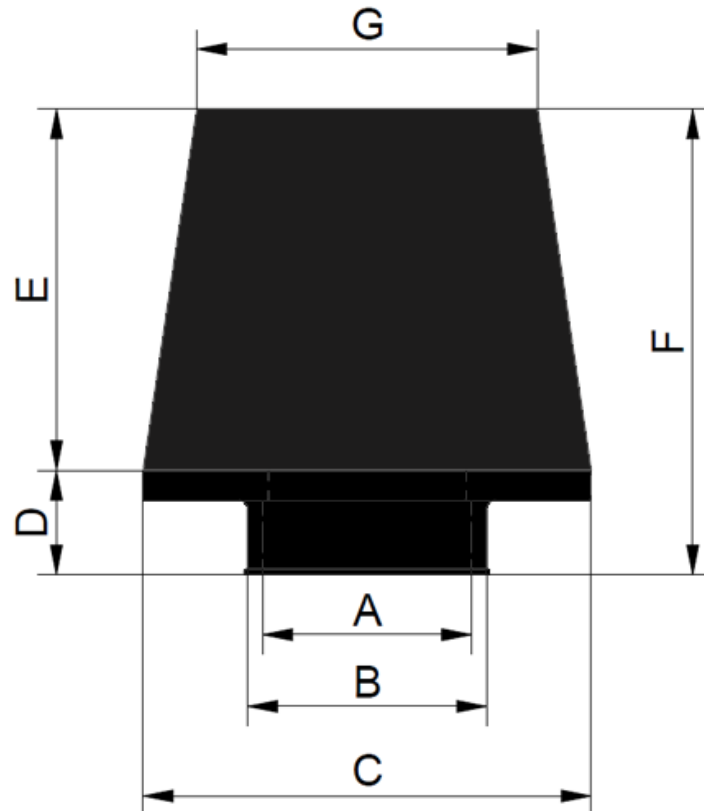

Part Number	A	B	C	D	E	F	G
	Neck	Neck	Base	Base	Foam	Total	Top
	ID	OD	Diameter	Height	Height	Height	Diameter
JC60RN/70C	70	80	150	35	121	156	114
JC60RN/76C	76	86	150	35	121	156	114
JC60RN/80C	80	90	150	35	121	156	114

Website Link: <https://www.itgairfilters.com/product/jc60-rubber-neck-small-cone-jc60rnc/>



JC60/XXFC (Full Cone)

These JC60 filters are built onto our smaller 149mm diameter aluminium spinning. These filters use our small plastic filter support cage in 'full' and have a total foam height of 152mm.

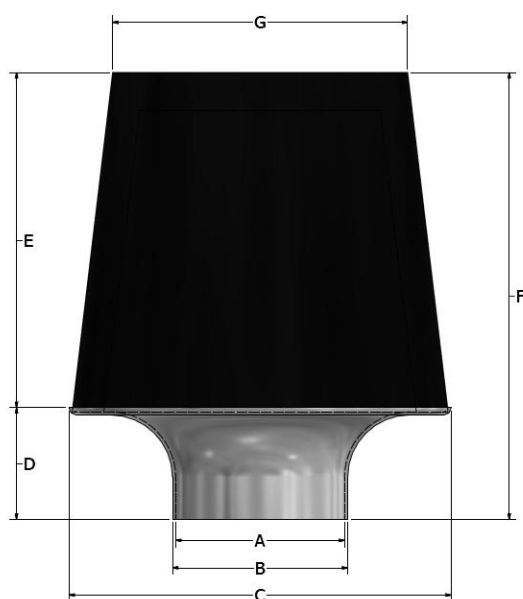

Part	A	B	C	D	E	F	G
Number	Neck	Neck	Spinning	Spinning	Foam	Total	Top
	ID	OD	Diameter	Height	Height	Height	Diameter
JC60/58FC	58	61	149	33	152	185	114
JC60/60FC	60	63	149	52	152	204	114
JC60/63FC	63	66	149	52	152	204	114
JC60/67FC	67	70	149	54	152	206	114
JC60/70FC	70	73	149	54	152	206	114
JC60/73FC	73	76	149	50	152	202	114
JC60/78FC	78	81	149	44	152	196	114
JC60/84FC	84	87	149	46	152	198	114

Website Link: <https://www.itgairfilters.com/product/jc60fc-full-cone-jc60fc/>



JC60RN/XXFC (Rubber Neck Full Cone)

These Rubber Neck filters are a direct equivalent filter to our conventional Aluminium Based JC60 Full Cone filters. They are to be used where a filter is required to clamp directly onto hard intake pipework – therefore eliminating the need for a silicone joiner section.

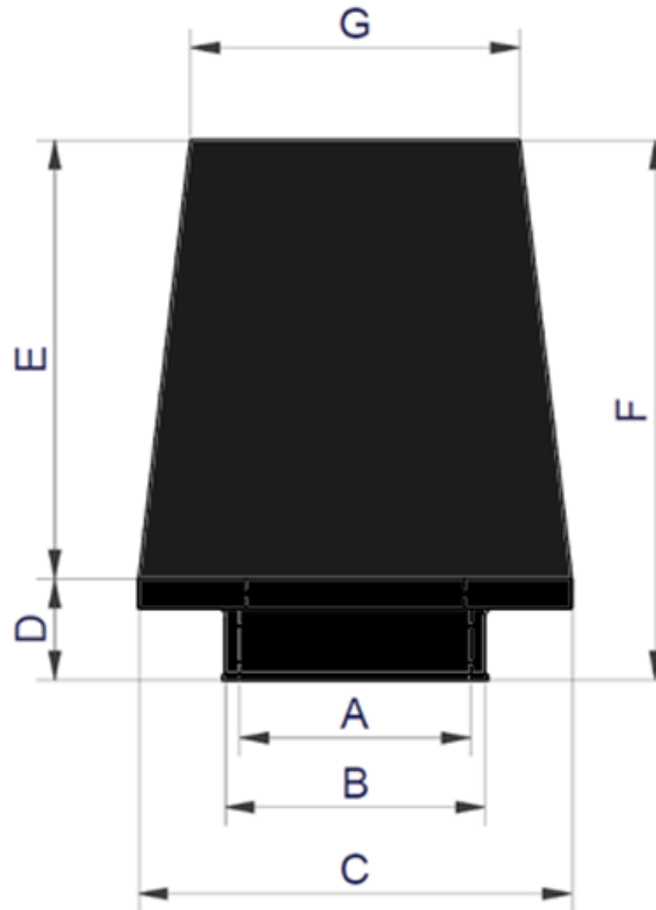

Part Number	A	B	C	D	E	F	G
	Neck	Neck	Base	Base	Foam	Total	Top
	ID	OD	Diameter	Height	Height	Height	Diameter
JC60RN/70FC	70	80	150	35	152	187	114
JC60RN/76FC	76	86	150	35	152	187	114
JC60RN/80FC	80	90	150	35	152	187	114

Website Link: <https://www.itgairfilters.com/product/jc60-rubber-neck-full-cone-jc60rnfc/>



JC60/XXC (Large Cone)

These JC60 filters are built onto our larger 180mm diameter aluminium spinning. These filters use our large plastic filter support cage in and have a total foam height of 163mm.

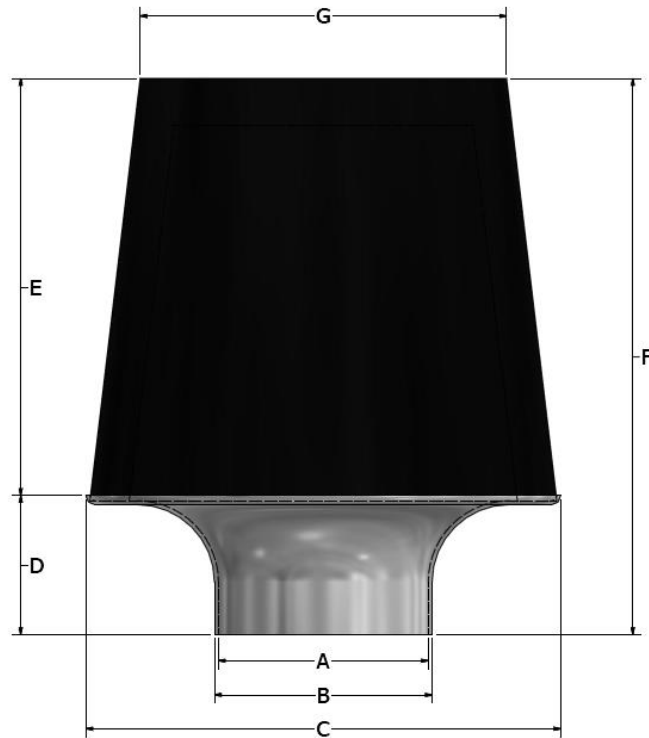

Part Number	A Neck ID	B Neck OD	C Spinning Diameter	D Spinning Height	E Foam Height	F Total Height	G Top Diameter
JC60/80C	80	83	180	55	163	218	149
JC60/86C	86	89	180	53	163	216	149
JC60/93C	93	96	180	50	163	213	149
JC60/99C	99	102	180	50	163	213	149
JC60/114C	114	117	180	45	163	208	149
JC60/124C	124	127	180	40	163	203	149

Website Link: <https://www.itgairfilters.com/product/jc60c-large-cone-jc60cl/>



JC60RN/XXC (Rubber Neck Large Cone)

These Rubber Neck filters are a direct equivalent filter to our conventional Aluminium Based JC60 Large Cone filters. They are to be used where a filter is required to clamp directly onto hard intake pipework – therefore eliminating the need for a silicone joiner section.

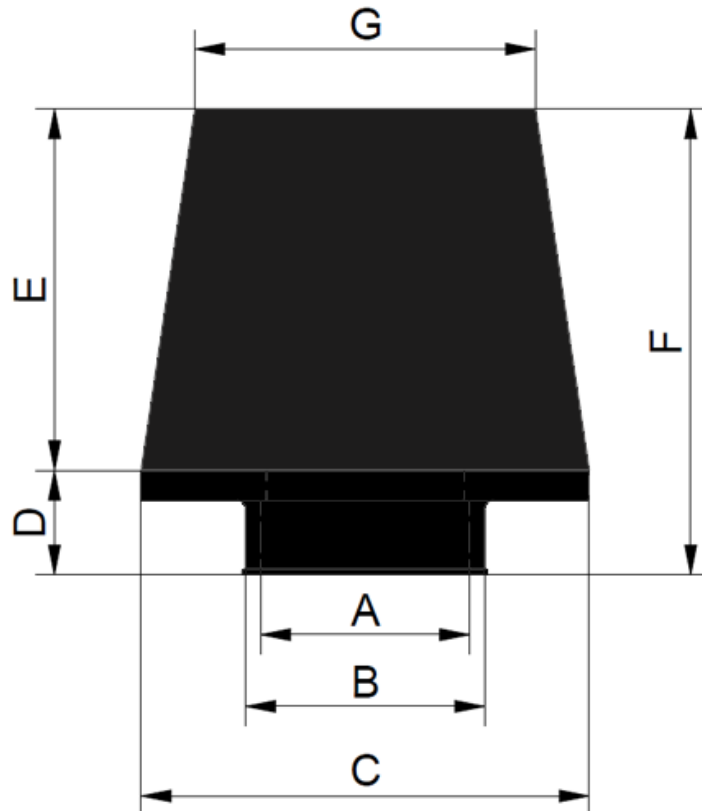

Part Number	A	B	C	D	E	F	G
	Neck	Neck	Base	Base	Foam	Total	Top
	ID	OD	Diameter	Height	Height	Height	Diameter
JC60RN/89C	89	99	180	35	163	198	149
JC60RN/102C	102	112	180	35	163	198	149
JC60RN/114C	114	124	180	35	163	198	149
JC60RN/127C	127	137	180	35	163	198	149

Website Link: <https://www.itgairfilters.com/product/jc60-rubber-neck-large-cone-jc60rnc/>



JC60/XXMM (Mega Maxogen)

The Mega Maxogen filters are a new addition to the ITG product range. These JC60 filters are built onto our larger 180mm diameter aluminium spinning and also use a reinforced internal plastic cage. These are designed for high power applications where the space is available.

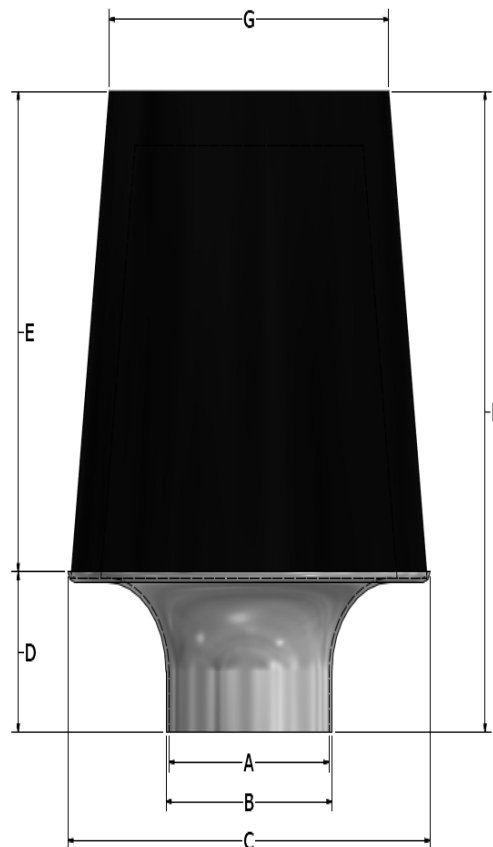

Part Number	A	B	C	D	E	F	G
	Neck	Neck	Spinning	Spinning	Foam	Total	Top
	ID	OD	Diameter	Height	Height	Height	Diameter
JC60/80MM	80	83	180	55	290	345	114
JC60/86MM	86	89	180	53	290	343	114
JC60/93MM	93	96	180	50	290	340	114
JC60/99MM	99	102	180	50	290	340	114
JC60/114MM	114	117	180	45	290	335	114
JC60/124MM	124	127	180	40	290	330	114

Website Link: <https://www.itgairfilters.com/product/jc60-mega-maxogen-jc60mm/>



JC60RN/XXMM (Rubber Neck Mega Maxogen)

These Rubber Neck filters are a direct equivalent filter to our conventional Aluminium Based JC60 Mega Maxogen filters. They are to be used where a filter is required to clamp directly onto hard intake pipework – therefore eliminating the need for a silicone joiner section.

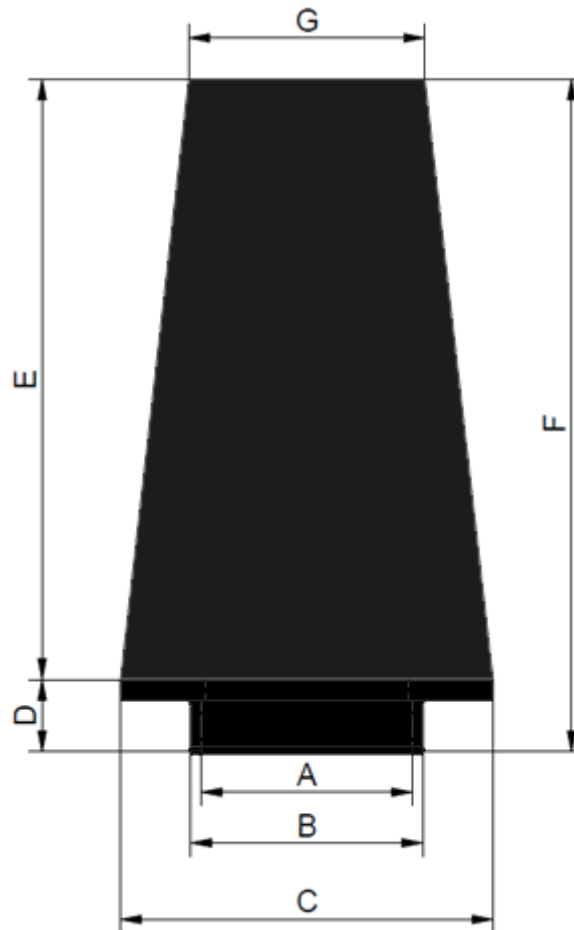

Part Number	A	B	C	D	E	F	G
	Neck	Neck	Base	Base	Foam	Total	Top
	ID	OD	Diameter	Height	Height	Height	Diameter
JC60RN/89C	89	99	180	35	290	325	114
JC60RN/102C	102	112	180	35	290	325	114
JC60RN/114C	114	124	180	35	290	325	114
JC60RN/127C	127	137	180	35	290	325	114

Website Link: <https://www.itgairfilters.com/product/jc60-rubber-neck-mega-maxogen-jc60rnmm/>